

DIN CLASSIFICATIONS

(DIN's 1 - 74361)

DIN 1 Taper Pins

DIN 7 Dowel Pins

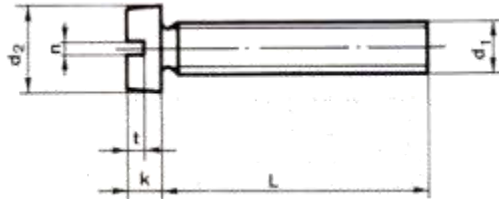

DIN 84A Slotted Cheese head machine screws

DIN 84 Z1 Slott. cheese hd assem. scrs. w/capt. f/w

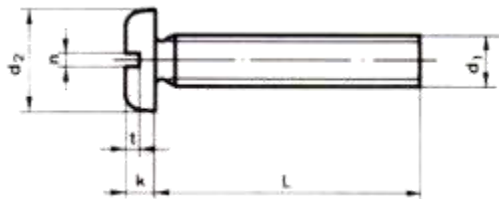

DIN 85 A Slotted pan head machine screws

DIN 93 Tab washers with long tab

DIN 94 Cotter pins

DIN 95 Slotted oval head machine screws

DIN 96 Slotted round head wood screws

DIN 97 Slotted flat head wood screws

DIN 103 Acme threaded rod

DIN 124 Round head rivets

DIN 1151 B Flat head nails

DIN 1433 Clevis pins without head

DIN 1434 Clevis pins w/out hold for split pins

DIN 1435 Clevis pins with small head

DIN 1436 Clevis pins with large head

DIN 1440 Flat washers with clevis pins, medium

DIN 1441 Flat washers for clevis pins, coarse

DIN 1443 Clevis pins without head

DIN 1444 Clevis pins with head

DIN 1445 Clevis pins with head and threaded portion

DIN 1469 Grooved pins half length grooved

DIN 1470 Grooved pins full length parallel grooved

DIN 1471 Grooved pins full length taper grooved

DIN 1472 Grooved pins half length taper grooved

DIN 1473 Grooved pins full length paralleled grooved

DIN 1474 Grooved pins half length reverse grooved

DIN 1475 Grooved pins third length center grooved

DIN 1476 Round head grooved pins

DIN 1477 Flat countersunk head grooved pins

DIN 1479 Turnbuckle nuts

DIN 1480 Turnbuckles

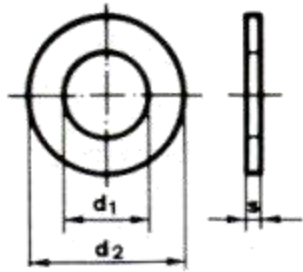

DIN 125 A Flat washer without chamfer

DIN 125 B Flat washer with chamfer

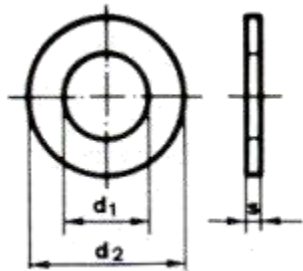

DIN 126 Flat washer without chamfer



DIN 127A Split lock washer with bend ends

DIN 127 B Split lock washer with flat ends

DIN 128 A Split spring washers, curved

DIN 128 B Split spring washers, waved

DIN 137 A Spring washer, curved

DIN 137 B Spring washer, waved

DIN 1481 Spring pins, heavy duty

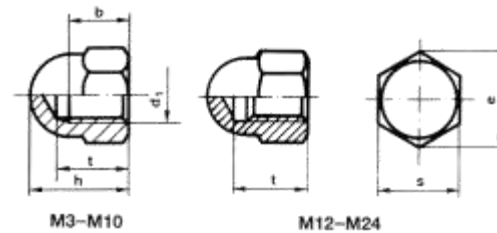

DIN 1587 Hexagon domed cap nuts , full pattern

DIN 1804 w Slotted round nuts

DIN 1816 Round nuts with set pin holes

DIN 2093 A,B,C Disc springs (Belleville type)

DIN 2509 Double end studs

DIN 2510 L Stud bolts with reduced shank

DIN 2510 NF Hexagon nuts for stud bolts

DIN 3017 Hose clamps

DIN 3090 Wire robe thimbles

DIN 3570 A U-Bolts

DIN 5401 Balls: hardened ground and polished

DIN 5406 Lock washers for lock nuts Din 981

DIN 6325 Parallel pins hardened

DIN 6330 Hexagon nuts - 1,5d

DIN 6331 Hexagon nuts with collar

DIN 6334 Hexagon nuts - 3d

DIN 186 A Tee-head bolts with square head

DIN 188 Tee-head bolts with double nip

DIN 258 Taper pins with external thread

DIN 261 Tee-head bolts

DIN 302 Countersunk head rivets

DIN 315 Wing nuts

DIN 316 Wing screws

DIN 404 Slotted drilled fillister head screws

DIN 417 Slotted set screws with full dog point Taper pins

DIN 427 Slotted headless screws

DIN 431 Jam nut, hexagonal

DIN 432 External tab washer

DIN 433 Flat washer with reduced O.D.

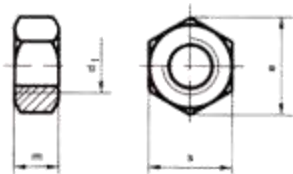

DIN 434 Square bevel washer: 8%

DIN 435 Square bevel washer: 14%

DIN 436 Square washer

DIN 438 Slotted set screw with cup point

DIN 439 A Hexagon nuts - 0,5d unchamfered

DIN 6340 Plain washers hardened

DIN 6796 Conical spring washers (Belleville type)

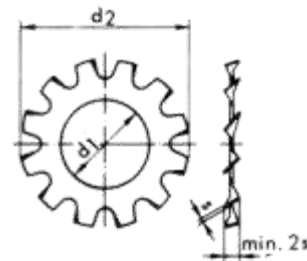

DIN 6797 A+J Internal/external tooth lock washers

DIN 6797 AZ Tooth lock washers (type AZ)

DIN 6797 IZ Tooth lock washers (type JZ)

DIN 6797 AZV Tooth lock washers (type AZV)

DIN 6798 A+J Serrated lock washers

DIN 6798 AZ Serrated lock washers (type AZ)

DIN 6798 IZ Serrated lock washers (type JZ)

DIN 6798 AZV Serrated lock washers (type AZV)

DIN 6798 V 90degree Countersunk serrated lock washers

DIN 6799 Circlips for shafts

DIN 6880 Bright key stock

DIN 6885 A Parallel keys, round ended

DIN 6885 B Parallel keys, square ended

DIN 6887 Taper keys with gid head

DIN 6888 Woodruff keys

DIN 439 B Hexagon nuts - 0,5d chamfered

DIN 440 R Round washers for wood constructions

DIN 443 A Sealing push in caps

DIN 444 A Eye bolts

DIN 462 Internal tab washers

DIN 463 Tab washers with long and short tab

DIN 464 Knurled thumb screws

DIN 465 Slotted knurled thumb screws

DIN 466 Knurled nuts, full

DIN 467 Flat knurled nuts

DIN 470 Sealing washers

DIN 471 External retaining rings

DIN 472 Internal retaining rings

DIN 478 Square head bolts

DIN 479 Square head bolts

DIN 480 Square head bolts

DIN 525 Weld studs with hexagon nuts

DIN 529 A Anchor bolts (stone bolt)

DIN 529 B Anchor bolts (stone bolt)

DIN 529 C Masonry bolts with hexagon nuts

DIN 529 D Anchor bolts (stone bolt)

DIN 6900 Screw and washer assemblies (Sems)

DIN 6901-6908 Tapping screws assemblies (Sems)

DIN 6911 Hexagon socket screw keys with pilot

DIN 6912 Low head socket cap screws with pilot

DIN 6913 Spring washers with safety rings

DIN 6914 Hex bolts for high strength struct. bolting

DIN 6915 Hex nuts for high strength struct. bolting

DIN 6916 Washers for high strength structural bolting

DIN 6917 Structural bevel washers: 14%

DIN 6918 Structural bevel washers: 8%

DIN 6921 Hexagonal flange bolts

DIN 6923 Hexagonal flange nuts

DIN 6924 Self-locking hex nuts, non-metallic insert

DIN 6925 Self-locking nuts, all-metal construction

DIN 6926 Self-locking hex flange nuts: non metallic insert

DIN 6927 Self locking hex flange nuts: all-metal construction

DIN 7331 A Compression rivets

DIN 7338 A,B,C Rivets for brake and clutch linings

DIN 7339 Tubular rivets

DIN 7340 A Tubular rivets with flat head

DIN 7341 A Rivet pins

DIN 529 E Foundation bolts with hexagon nuts

DIN 529 F Anchor bolts (stone bolt)

DIN 546 Slotted round nuts

DIN 547 Round nuts with drilled holes in one face

DIN 548 Round nuts with set pin hole in side

DIN 551 Slotted set screws with flat point

DIN 553 Slotted set screws with cone point

DIN 555 Hexagon nuts - 0,8d

DIN 557 Square nuts

DIN 558 Fully threaded machine bolts

DIN 561 B Hexagon set screw with full dog point

DIN 562 Square thin nuts

DIN 564 Hex set screw w/half dog pt. and cone end

DIN 571 Hexagon lag screws

DIN 580 Lifting eye bolts

DIN 582 Lifting eye nuts

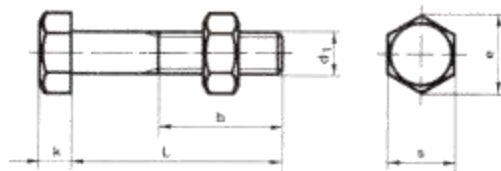

DIN 601 Hexagon bolts with hexagon nuts

DIN 7341 B Rivet pins

DIN 7343 Coiled pins, medium duty

DIN 7344 Coiled pins, heavy duty

DIN 7346 Spring type straight pins light duty

DIN 7349 Flat washers with large ext. diameter

DIN 7500 A Slotted cheese head thread forming screws

DIN 7500 C Cross rec. pan head thread forming screws

DIN 7500 D Hexagon head thread forming screws

DIN 7500 K Flat head thread forming screws



DIN 7500 M Cross rec, flat head thread forming screws

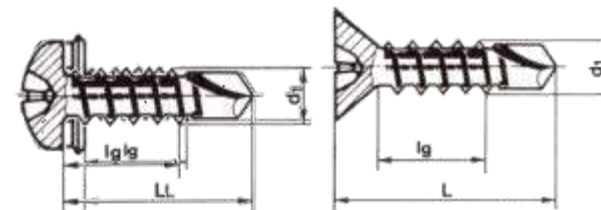

DIN 7504
K,N,P Self
drilling screws
with tapping



screws thread

DIN 7513 A Hex head thread cutting screws

DIN 7513 B Cheese head thread cutting screws

DIN 7513 C Self tapping screws - round head

DIN 7513 D Self tapping screws - flat head

DIN 7513 E Self tapping screws - oval head

DIN 7513 F Flat head thread cutting screws

DIN 7514 Drive screw, round head

DIN 7515 Drive screws, flat head

DIN 7516 A,B,C,D,E Thread cutting screws, cross rec. head screws

DIN 7603 A+C Sealing rings

DIN 7604 A+C Hexagon head pipe plugs

DIN 7964 Hexagon bolts with reduced shank

DIN 7965 Screwed inserts

DIN 7967 Safety nuts PAL (R)

DIN 7968 Hexagon fit bolts for steel structures

DIN 7969 Countersunk head bolts with forged slot

DIN 603 Mu Carriage bolts with hexagon nuts

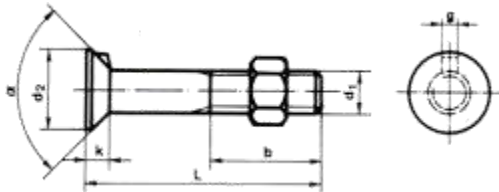

DIN 604 Flat countersunk nip bolts with hex nuts

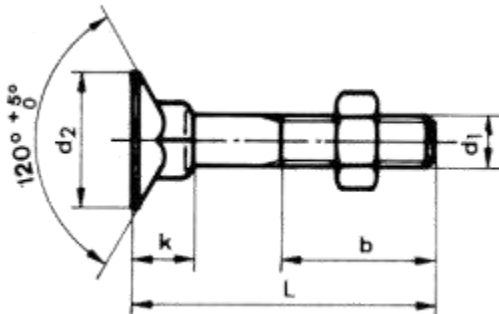

DIN 605 Flat countersunk square neck bolts

DIN 607 Mu Round head nip bolts with nuts

DIN 608 Countersunk square bolts (short neck)

DIN 609 Hex fitting bolts w/long threaded portion

DIN 610 Hex fitting bolts w/ short threaded portion

DIN 653 Flat knurled thumb screws

DIN 660 Round head rivets

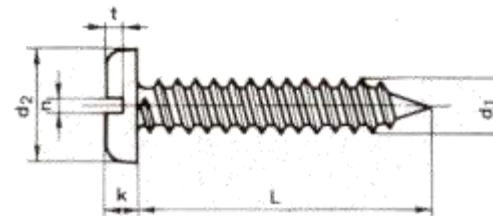

DIN 661 Countersunk head rivets

DIN 662 Mushroom head rivets

DIN 674 Oval (Brazier) head rivets

DIN 675 Flat countersunk head rivets

DIN 705 A Shaft collars

DIN 787 T-bolts for machine-tool table-slot

DIN 792 Cylindrical countersunk screws

DIN 797 Special foundation bolts

DIN 798 Special foundation nuts

DIN 833 Stud for cast iron

DIN 834 Stud for cast iron

DIN 835 Fo Studs, tap ends - 2d

DIN 836 Stud for aluminum

DIN 906 Hexagon socket pipe plugs

DIN 907 Core plugs

DIN 908 Hexagon socket screw plugs

DIN 909 Hexagon head pipe plugs

DIN 910 Hexagon head screw plugs

DIN 911 Hexagon socket screw keys

DIN 7971 B (BZ) Slotted pan head tapping screws

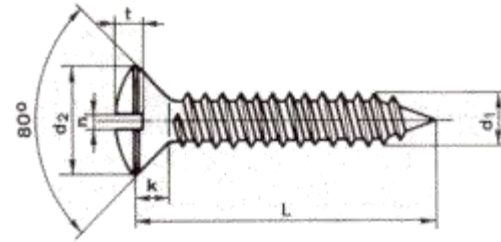

DIN 7972 B (BZ) Slott. flat hd tapping screws, hd angle 80 deg.

DIN 7973 B Slott. oval hd tapping screws, hd angle 80 deg

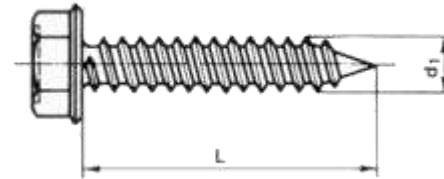

DIN 7976 BZ Hexagon head tapping screws

DIN 7977 Taper pins with external thread

DIN 7978 A Taper pins with internal thread

DIN 7979 Dowel pins with internal thread

DIN 7980 Hi-collar lock washers

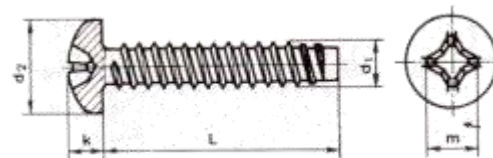

DIN 7981 B (BZ) Cross recessed pan head tapping screws

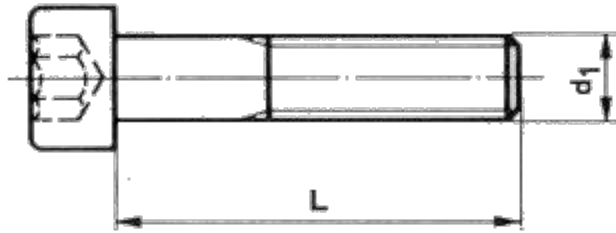

DIN 912 Socket head cap screws

DIN 913 Socket set screws with flat point

DIN 914 Socket set screws with cone point

DIN 915 Socket set screws with dog point

DIN 916 Socket set screws with cup point

DIN 917 Hexagon cup nuts - low pattern

DIN 920 Slotted pan head screws, small head

DIN 921 Slotted pan head screws with large head

DIN 922 Pan head screws with small head and dog point

DIN 923 Slotted pan head screws with shoulder

DIN 924 Oval head screws with dog point

DIN 925 Flat head screws with dog point

DIN 926 Slotted headless screws with full dog point

DIN 927 Slotted shoulder screws

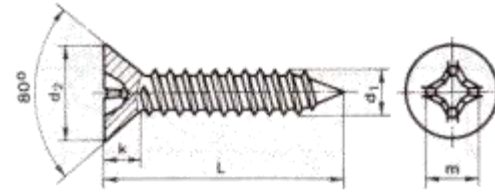

DIN 7982 B Cross rec. flat head tapping screw, hd angle 80

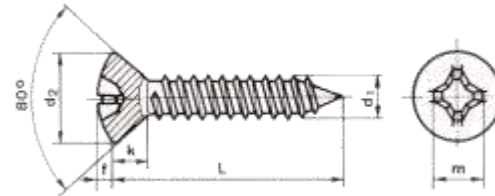

DIN 7983 B Cross rec. oval head tapping screw, hd angle 80

DIN 7984 Socket low head cap screws

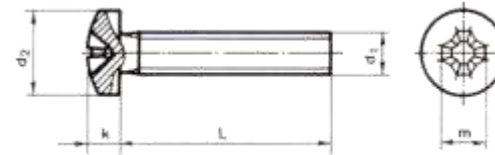

DIN 7985 A Cross recessed pan head machine screws

DIN 7985 Z1 Cr. rec. pan head screws w/captive flt. washer

DIN 7985 Z4 Cr. rec. pan head screws w/captive l/washer

DIN 7989 A Washers for steel constructions

DIN 7990 Hexagon bolts for steel structures



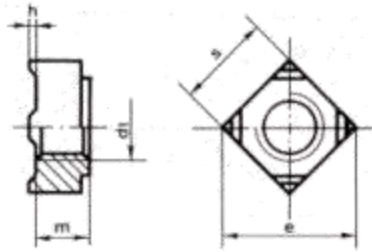

DIN 7991 Flat socket head cap screws

DIN 7992 Tee-head bolts with large head

DIN DIN 7993 A Snap rings for shafts

DIN 7993 B Snap rings for bores

DIN 7995 Cross recessed oval head wood screws

DIN 7996 Cross recessed round head wood screws

DIN 7997 Cross recessed flat head wood screws

DIN 9021 B Washer, plain, large

DIN 15237 Screw for belt, large head, plate shape

DIN 16903 (A+S) Insert nuts for plastic moldings

DIN 22424 A Triangular head screws

DIN 22425 Triangle nuts with collar

DIN 25195 Countersunk bolts with double nip

DIN 32501 Weld studs

DIN 46288 A Connecting washers for terminals

DIN 46288 B Connecting washers for terminals

DIN 70952 A Locking plates for slotted round nuts

DIN 71022 Slotted screwed sealing plugs

DIN 71412 Grease fittings 45 degree

DIN 71412 Grease fittings 90 degree

DIN 928 Square weld nuts

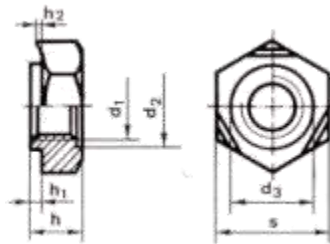

DIN 929 Hexagon weld nuts

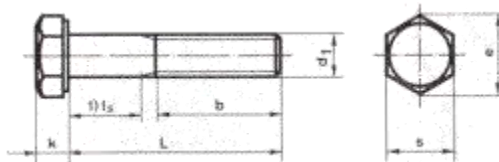

DIN 931 Hexagon cap screws partially threaded

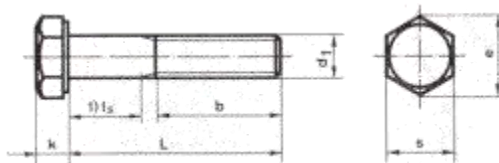

DIN 933 Hexagon cap screws fully threaded

DIN 933 Sz Hexagon cap screws with slot

DIN 71752 Clevis yokes

DIN 71803 A Ball studs with threaded neck for angle joints

DIN 71803 B Ball studs with rivet neck for angle joints

DIN 71805 A,B Ball seats with snap ring for angle joints

DIN 74361 A,B,C Spring washers for disc wheels

DIN 80705 Small pattern hex nuts

DIN 934 Hexagon nuts - 0,8d

DIN 935 Castle nuts

DIN 936 Hexagon jam nuts

DIN 937 Hexagon thin slotted and castle nuts

DIN 938 Studs, tap end - 1d

DIN 939 Studs, tap end - 1,25d

DIN 940 Studs, tap end - 2,5d

DIN 960 Hex cap screws, metric fine thread - part thread

DIN 961 Hex cap screws,
metric fine thread - full
thread

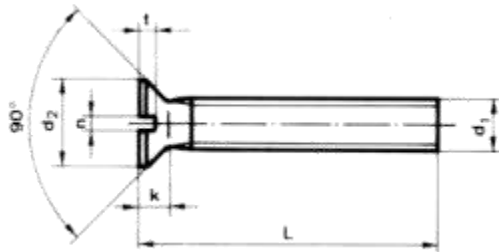

DIN 963 A Slotted flat head machine screws

DIN 964 A Slotted oval
head machine screws



DIN 965 A Cross recessed flat head machine screws

DIN 966 A Cross recessed oval head machine screws

DIN 970 Hex nuts style 1, prod. grade A+B

DIN 971/1 Hex nuts style 1, metric fine thread

DIN 971/2 Hex nuts style 2, metric fine thread

DIN 972 Hex nuts style 1, product grade C

DIN 975 Threaded rods

DIN 976 B Full threaded studs

DIN 979 Thin slotted and castle nuts

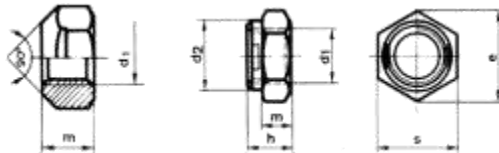

DIN 980 V Self-locking nuts; all metal construction

DIN 981 Lock nuts for rolling bearings

DIN 982 Self-locking nuts w/nylon insert: heavy series

DIN 983 External retaining rings with lugs

DIN 984 Internal retaining rings with lugs

DIN 985 Self locking nuts w/locking insert: standard series

DIN 986 Self locking domed cap nuts with nylon insert

DIN 988 Shim washers

NON STANDARD FASTENERS

M1 Flange socket head screws

M2 Socket hd cap screw w/special low head

M3 Socket head shoulder screws

M4 Socket button head screws

M5 Blanks, hex cap screws, not threaded

M6 Hexagon flange bolts

M7 Hexagon flange bolts

M8 Hexagon flange bolts

M9 Hexagon serrated flange bolts

M10 Hexagon nuts

M11 Hexagon flange nuts

M12 Hexagon flange nuts

M13 Hexagon flange nuts

M35 B7 threaded rod

M36 Hose clamps, light-duty and heavy duty range

M37 Flat washer w/out hole

M38 Conical spring washers

M39 Ribbed lock washer

M40 Safety spring lock washer

Jac I+II

M41 Shim washers

M42 Wire circlips

M43 Crescent rings for shafts

M44 Grip rings for shafts w/out grooves

M45 Speed nuts push-on type

M46 Drill rod

M47 Hammer drv scrws type U

M48 Spring cotter of a bolt

M49 Clamping rings, light duty

M50 Articulated joints

M51 Scrws for plastic (PT) (R)

M52 Thread cutting screws

M53 Hanger bolts

M14 Hex flange nuts w/nylon insert

M15 Sealing nuts, self-locking, Seal Lock

M16 Hex nuts assem. w/lock washers

M17 Hex nuts w/con. spring washer

M18 Hexagon serrated flange nuts

M19 Spot weld nuts

M20 Rivet bushings

M21 Pressed insert nuts

M22 Blind rivet nuts

M23 Blind rivet nuts, Tubtara (R)

M24 Slott countersunk nuts 110 deg

M25 Tee nuts

M26 Spring nuts U-Type for tapping screws

**M27 Speed nuts for self tapping/
metric screws**

M28 Bent eye screws

M29 Suspension screws

M30 Thumb screws

M31 Plastic anchors

M32 Truss head screws

M33 Slott flat trim hd mach. screws

M54 Bent eye wood screws

M55 Hook wood screws

M56 Square hook wood screws

M57 Chipboard screws

M58 Protection plugs plastic

M59 Kalei press nut

M60 Drive-in nut (Tee-nut)

**M61 Connecting nut (3XD),
class: 5S**

M62 "O" Rings Rubber only

M63 Spire speed nut

M64 Self drilling screws

M65 Locking spring pin

M66 Blind rivets

M67 Freeze plugs

M68 Freeze plug (Cup type)

M34 Thumb screws-knobs